

Performance curves

CR(E), CRI(E), CRN(E) 10

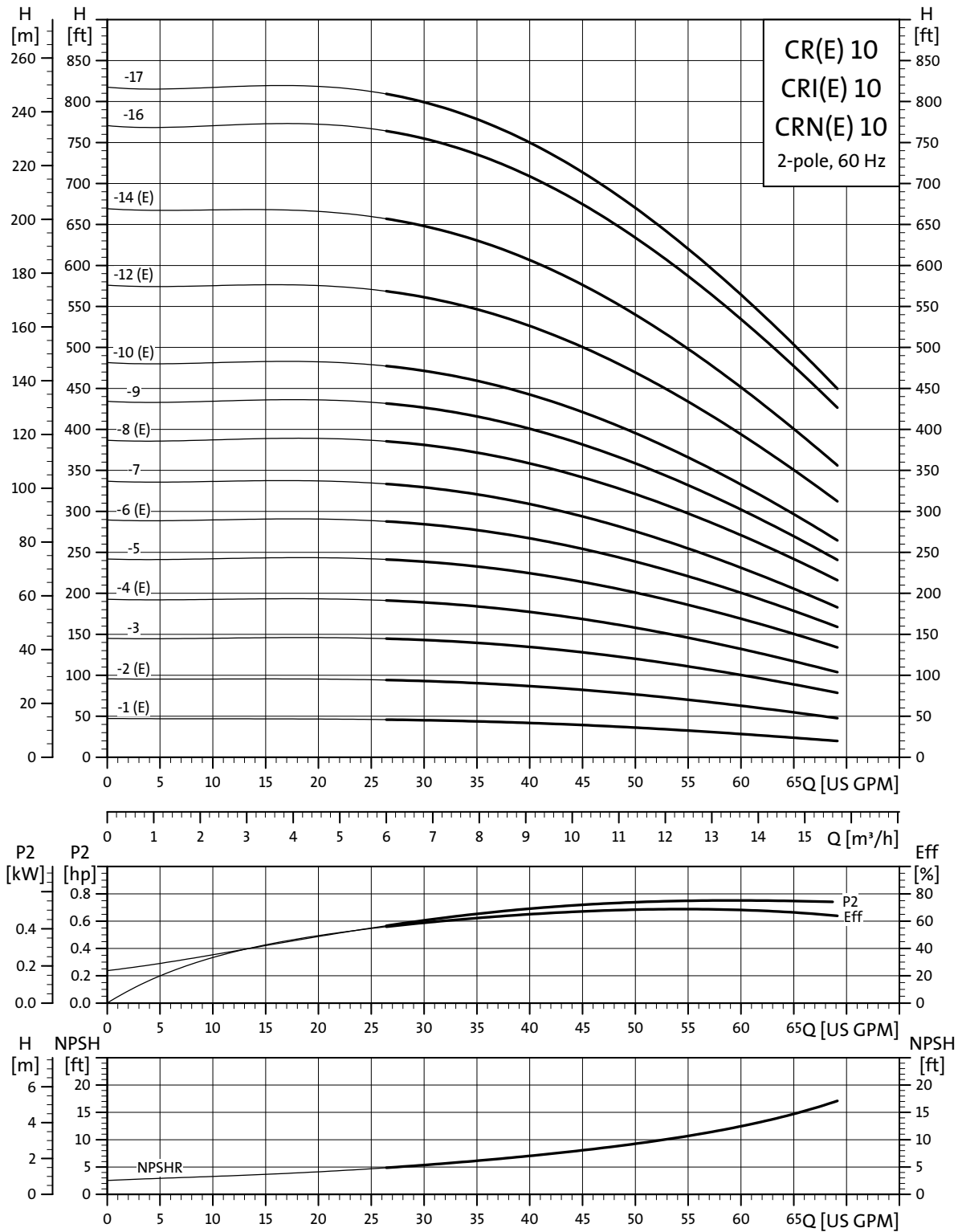

TM02 7221 5103

Dimensional sketches

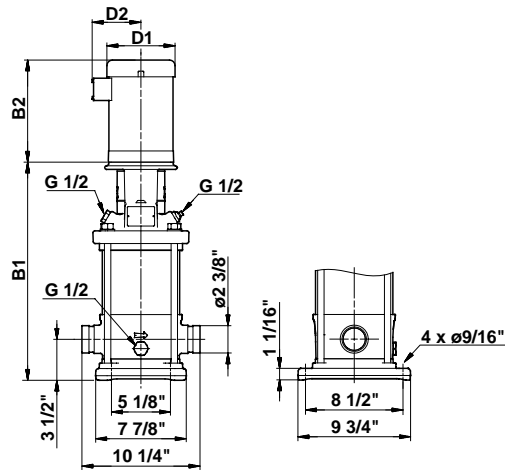

TM02 8478 0204

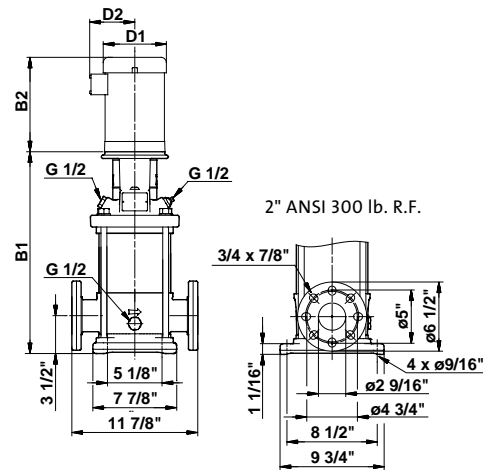

TM02 8476 0204

Dimensions and weights

Pump type	Hp	Ph	Voltage	NEMA Frame size	PJE B1	ANSI B1	ODP		TEFC		PJE ODP B1+B2	PJE TEFC B1+B2	ANSI ODP B1+B2	ANSI TEFC B1+B2	PJE Ship Wt. ¹ [lbs.]	ANSI Ship Wt. ¹ [lbs.]	MLE		PJE MLE B1+B2	ANSI MLE B1+B2	PJE Ship Wt. ¹ [lbs.]	ANSI Ship Wt. ¹ [lbs.]
							D1	D2	D1	D2							D1	D2				
CRN(E) 10-1	1	3	115/208-230*	56C	15 1/4	15 1/4	6 1/4	4 7/8	6 1/4	5	26 1/4	25 1/4	26 1/4	25 1/4	92	103	5 1/2	5 1/2	24 3/8	24 3/8	74	83
			208-230/460	-	15 1/4	15 1/4	6 1/4	4 1/2	6 1/4	5	24 3/4	24 5/8	24 3/4	24 5/8	84	95	7	6 5/8	26 3/4	26 3/4	94	105
CRN(E) 10-2	1 1/2	3	115/208-230	56C	15 1/4	15 1/4	7 1/4	5 5/8	7 1/4	5 3/4	27	27	27	27	110	119	5 1/2	5 1/2	24 3/8	24 3/8	67	76
			208-230/460	-	15 1/4	15 1/4	7 1/4	5 5/8	7 1/4	5 3/4	26	26	26	26	101	112	7	6 5/8	26 3/4	26 3/4	105	116
CRN 10-3	3	3	115/208-230	182TC	17 1/8	17 1/8	8 1/2	6 3/4	8 5/8	6 7/8	31 5/8	31 5/8	31 5/8	31 5/8	161	169	-	-	-	-	-	-
			208-230/460	-	17 1/8	17 1/8	7 1/4	5 5/8	8 5/8	6 7/8	28 1/2	29 5/8	28 1/2	29 5/8	139	150	-	-	-	-	-	-
CRN(E) 10-4	3	3	115/208-230	182TC	18 3/8	18 3/8	8 1/2	6 3/4	8 5/8	6 7/8	32 7/8	32 7/8	32 7/8	32 7/8	161	172	-	-	-	-	-	-
			208-230/460	-	18 3/8	18 3/8	7 1/4	5 5/8	8 5/8	6 7/8	29 3/4	30 7/8	29 3/4	30 7/8	141	150	7 7/8	6 5/8	31 1/4	31 1/4	147	156
CRN 10-5	5	3	208-230	182TC	19 1/2	19 1/2	10 5/8	7 3/8	10 5/8	7 1/2	34 7/8	34 7/8	34 7/8	34 7/8	180	189	-	-	-	-	-	-
			208-230/460	-	19 1/2	19 1/2	7 1/4	5 5/8	8 1/2	6	33 5/8	35 1/2	33 5/8	35 1/2	158	167	-	-	-	-	-	-
CRN(E) 10-6	5	3	208-230	182TC	20 3/4	20 3/4	10 5/8	7 3/8	10 5/8	7 1/2	36 1/8	36 1/8	36 1/8	36 1/8	183	194	-	-	-	-	-	-
			208-230/460	-	20 3/4	20 3/4	7 1/4	5 5/8	8 1/2	6	34 7/8	36 3/4	34 7/8	36 3/4	161	169	8 3/4	7 1/2	35 3/8	35 3/8	184	192
CRN 10-7	5	3	208-230	182TC	21 7/8	21 7/8	10 5/8	7 3/8	10 5/8	7 1/2	37 1/4	37 1/4	37 1/4	37 1/4	185	196	-	-	-	-	-	-
			208-230/460	-	21 7/8	21 7/8	7 1/4	5 5/8	8 1/2	6	36	37 7/8	36	37 7/8	1638	172	-	-	-	-	-	-
CRN(E) 10-8	7 1/2	3	208-230	213TC	23 3/8	23 3/8	10 3/8	8 1/8	10 1/4	7 1/2	38 3/4	38 3/4	38 3/4	38 3/4	206	218	-	-	-	-	-	-
			208-230/460	-	23 3/8	23 3/8	10 3/8	8 1/8	10 1/4	8 1/8	38 3/4	38 3/4	38 3/4	38 3/4	187	198	8 3/4	7 1/2	38 7/8	38 7/8	217	228
CRN 10-9	7 1/2	3	208-230	213TC	24 1/2	24 1/2	10 3/8	8 1/8	10 1/4	7 1/2	39 7/8	39 7/8	39 7/8	39 7/8	209	220	-	-	-	-	-	-
			208-230/460	-	24 1/2	24 1/2	10 3/8	8 1/8	10 1/4	8 1/8	39 7/8	39 7/8	39 7/8	39 7/8	189	200	-	-	-	-	-	-
CRN(E) 10-10	7 1/2	3	208-230	213TC	25 3/4	25 3/4	10 3/8	8 1/8	10 1/4	7 1/2	41 1/8	41 1/8	41 1/8	41 1/8	211	222	-	-	-	-	-	-
			208-230/460	-	25 3/4	25 3/4	10 3/8	8 1/8	10 1/4	8 1/8	41 1/8	41 1/8	41 1/8	41 1/8	191	202	8 3/4	7 1/2	41 1/4	41 1/4	221	232
CRN(E) 10-12	10	3	230	213TC	28 1/8	28 1/8	10 5/8	7 1/2	10 1/4	10 3/8	44 5/8	44	44 5/8	44	242	251	-	-	-	-	-	-
			208-230/460	-	28 1/8	28 1/8	10 5/8	7 3/8	10 3/8	7 1/2	43 1/2	43 1/2	43 1/2	43 1/2	209	220	8 3/4	7 1/2	43 5/8	43 5/8	233	244
CRN(E) 10-14	10	3	230	213TC	30 1/2	30 1/2	10 5/8	7 1/2	10 1/4	10 3/8	47	46 3/8	47	46 3/8	246	255	-	-	-	-	-	-
			208-230/460	-	30 1/2	30 1/2	10 5/8	7 3/8	10 3/8	7 1/2	45 7/8	45 7/8	45 7/8	45 7/8	213	224	8 3/4	7 1/2	46	46	237	248
CRN 10-16	15	3	208-230/460	254TC	35 3/8	35 3/8	10 5/8	7 3/8	10 3/8	8 3/4	51 1/2	52	51 1/2	52	343	352	-	-	-	-	-	-
CRN 10-17	15	3	208-230/460	254TC	37 3/4	37 3/4	10 5/8	7 3/8	10 3/8	8 3/4	53 7/8	54 3/8	53 7/8	54 3/8	348	359	-	-	-	-	-	-

* TEFC voltage is 115/230

¹Weights based on pump with ODP motor (see price list for individual weights)
All dimensions in inches unless otherwise noted.